

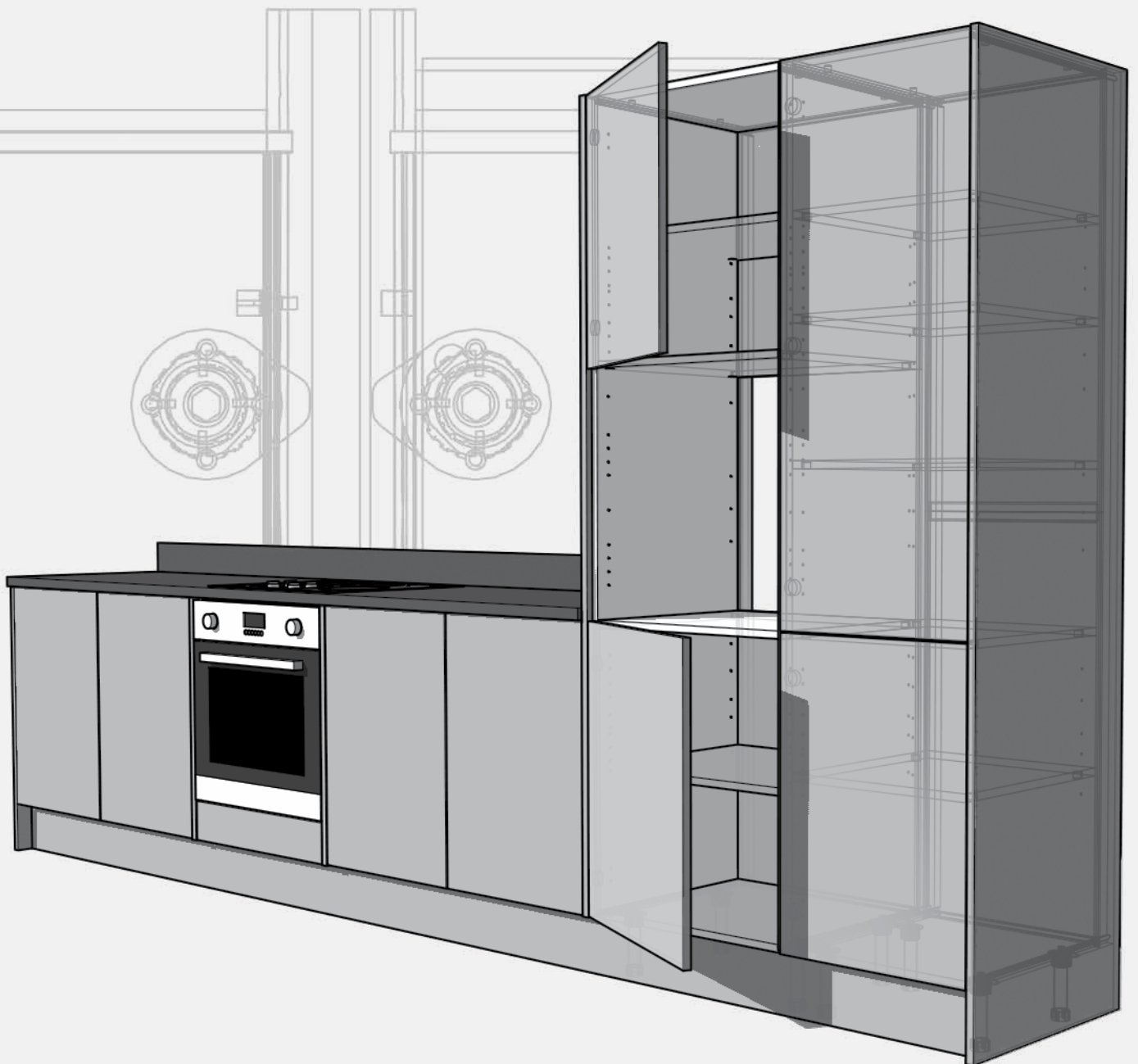

Tower Units

Installation Guide



Introduction

This guide is intended as a supplement to the assembly instructions supplied with individual cabinets. Due to the large variety of door and appliance configurations, a small number of modifications may be needed during installation as shown below.

This avoids the need for multiple drillings to the cabinet, which looks unsightly – and may only be needed on rare occasions.

NOTE

Ensure all tower cabinets are securely fixed to the wall using appropriate fixings to suit the wall type. See Appendix for more information on fixing cabinets to the wall.

Before you get stuck in; take five minutes to review this installation guide.

Please note the following points:

- Appliance Housing Back Panels will need to be cut to length to suit the chosen unit type – these sizes are shown on individual unit pages.
- In a limited number of configurations, such as drawer and fridge/freezer options, additional drilling is required to the cabinet ends – these positions are shown on individual unit pages.
- Take care to position fixed and adjustable shelves as shown on individual pages.
- Ensure the cabinet is fixed to the wall.

Back Panels

Back panel heights on appliance housing units vary depending on door configurations – cutting dimensions are shown on individual unit pages.

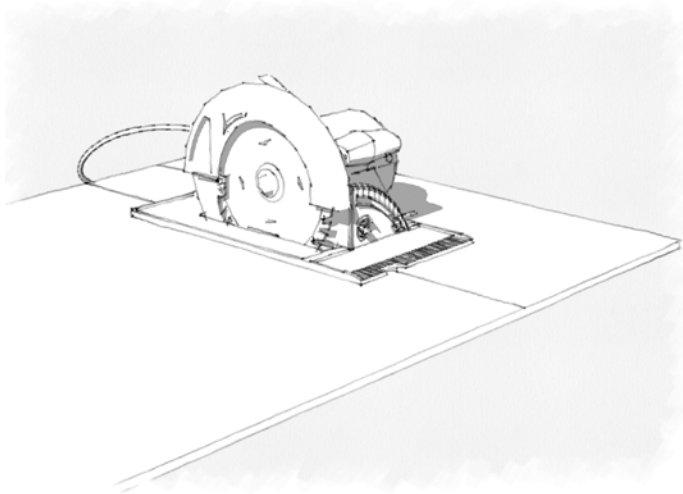

Hinge Plates

In some instances you will need to drill for hinge plates.

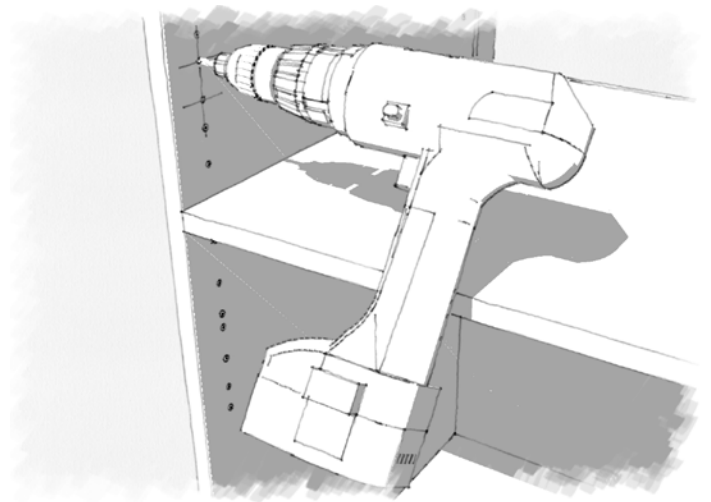

Shelves

Note that Larder units (300, 400, and 500 wide) are supplied with 1x Fixed and 3x adjustable shelves. 600 wide Appliance housings are supplied with 3x Fixed and 1x adjustable shelf. All appliances must have a fixed shelf above & below them – adjustable shelves are only intended for storage purposes.

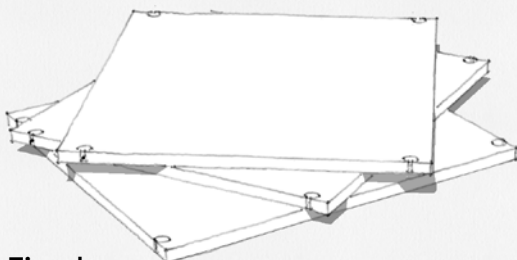

Fixed

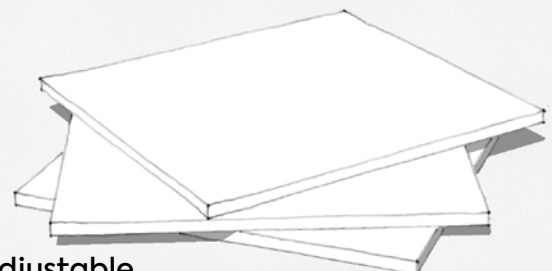

Adjustable

Contents

Introduction	i
Contents	ii
Kitchen Units	
Larder Units	
Larder Units (Standard Height) 300, 400 & 500 wide	1
Larder Units (Standard Height) 600 wide.....	2
Larder Units (Tall) 300, 400 & 500 wide.....	3
Larder Units (Tall) 600 wide	4
Integrated Cooking (Standard Height)	
Single Oven Units.....	5
Double Oven Units.....	6
Single Oven plus Compact/M-Wave Units.....	7
Compact/M-Wave Units.....	8
Integrated Cooking (Tall)	
Single Oven Units.....	9
Double Oven Units.....	10
Single Oven plus Compact/M-Wave Units.....	11
Compact/M-Wave Units.....	12
Integrated Cooling (Standard Height)	
70/30 Cooling	13
50/50 Cooling.....	14
Single Cooling	15
Integrated Cooling (Tall)	
70/30 Cooling	16
50/50 Cooling.....	17
Single Cooling	18
Appendix	
Fixing cabinets to the wall.....	A-1
Fixed Shelves	A-1
Fixed Dummy Fascias.....	A-1
Inner Drawers.....	A-2
Pan Drawers	A-3

Standard Height (300, 400 & 500 wide)

Larder Units

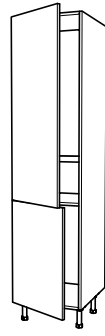

with
Two Doors

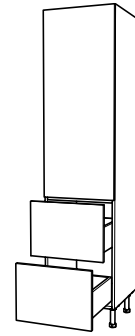

with
Pan Drawers

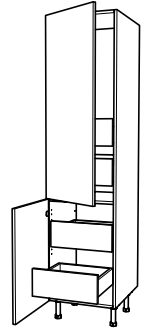

with
Inner Drawers

For drawer installation
see Appendix

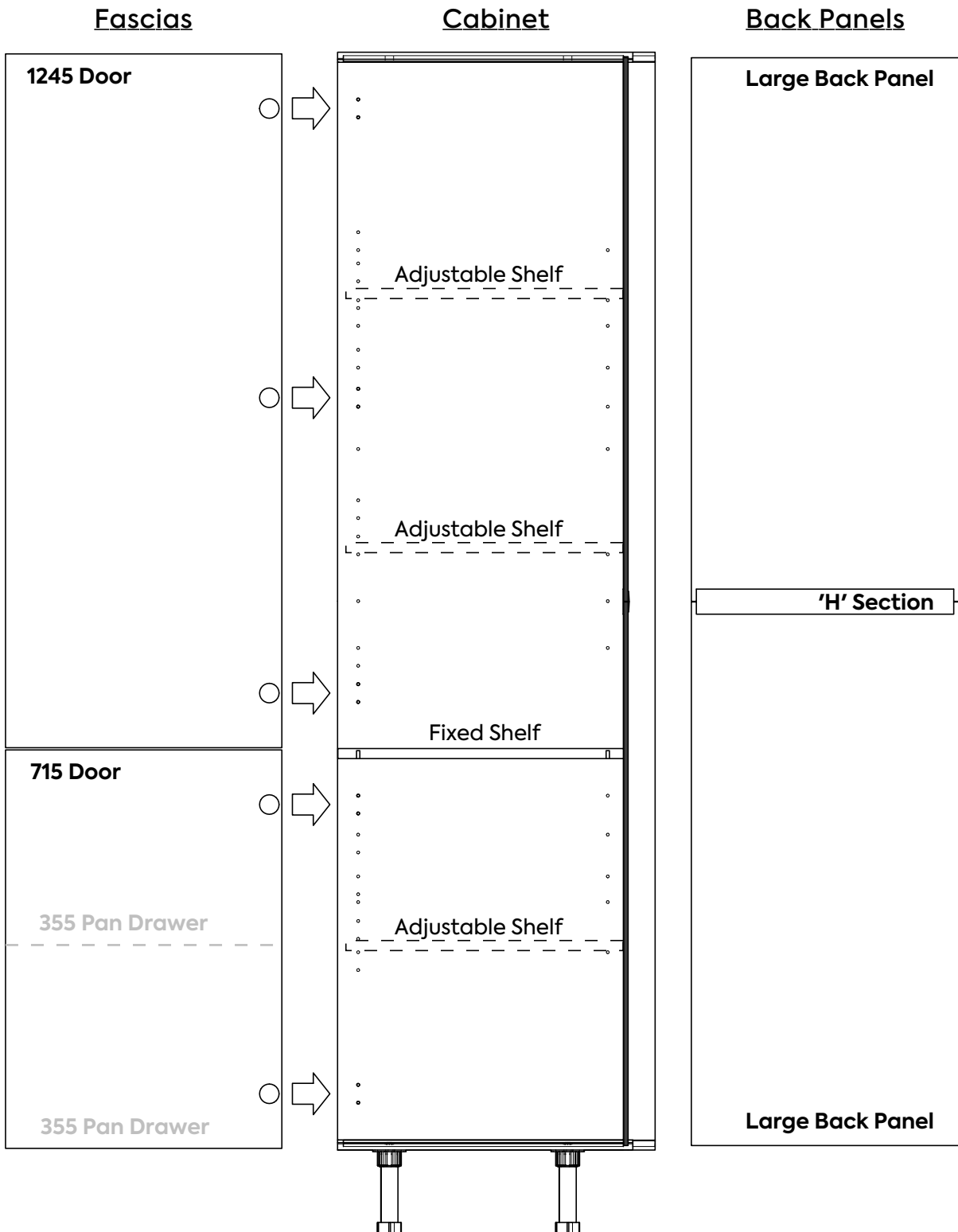

Standard Height (600 wide)

Larder Units

The primary function of this cabinet is as an appliance housing unit, however it can be used as a larder unit by fitting the three fixed shelves as shown

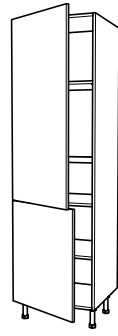

with
Two Doors

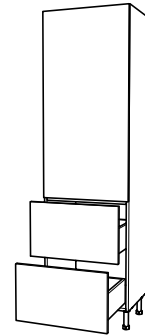

with
Pan Drawers

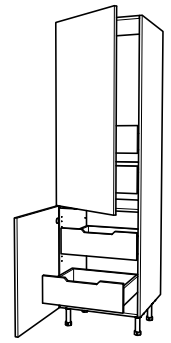

with
Inner Drawers

For drawer installation
see Appendix

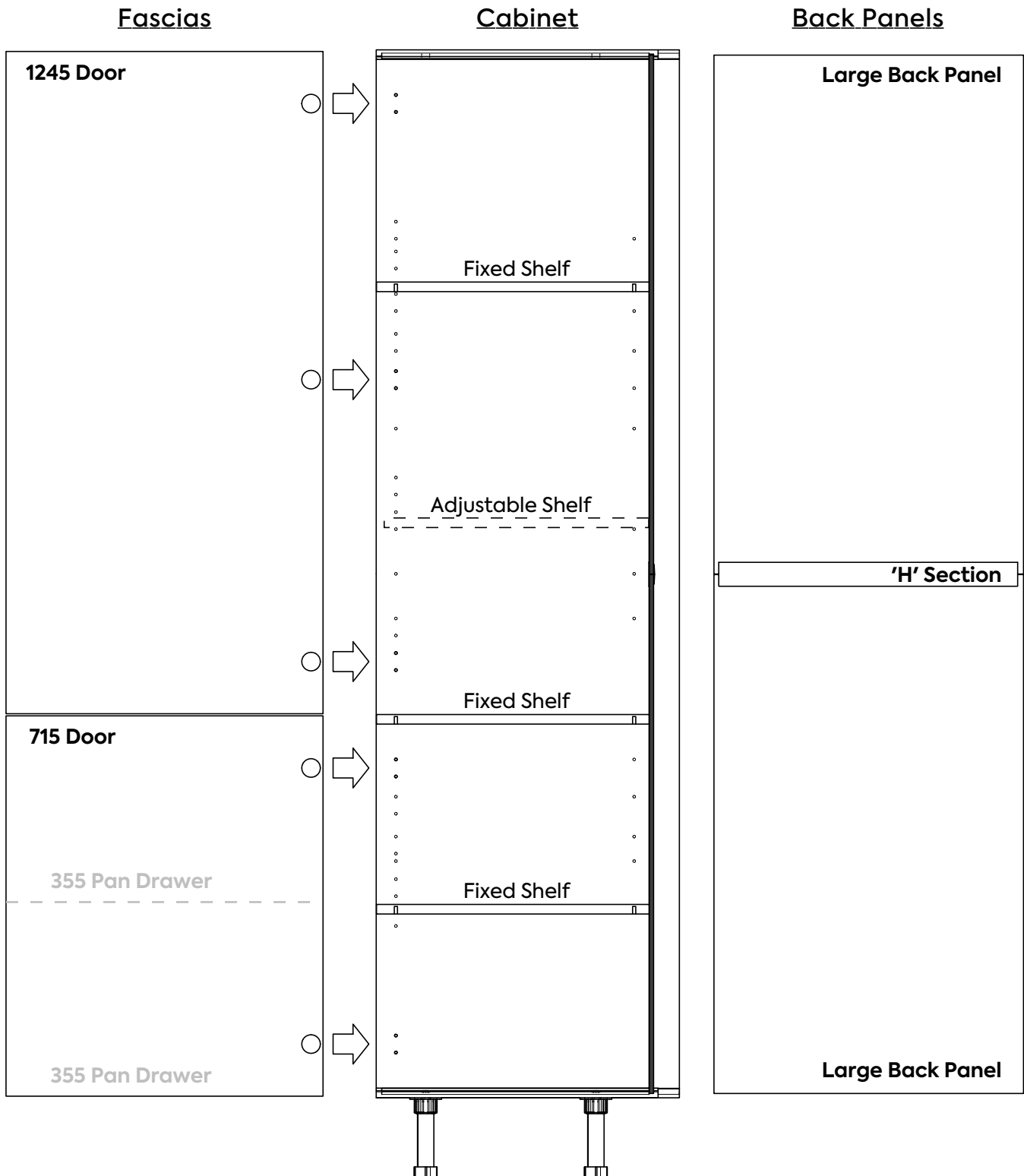

Tall Height (300, 400 & 500 wide)

Larder Units

For drawer installation
see Appendix

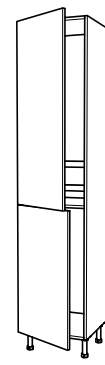

with
Two Doors

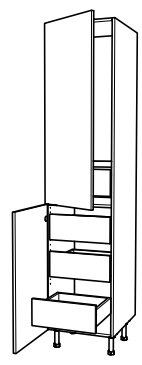

with
Inner Drawers

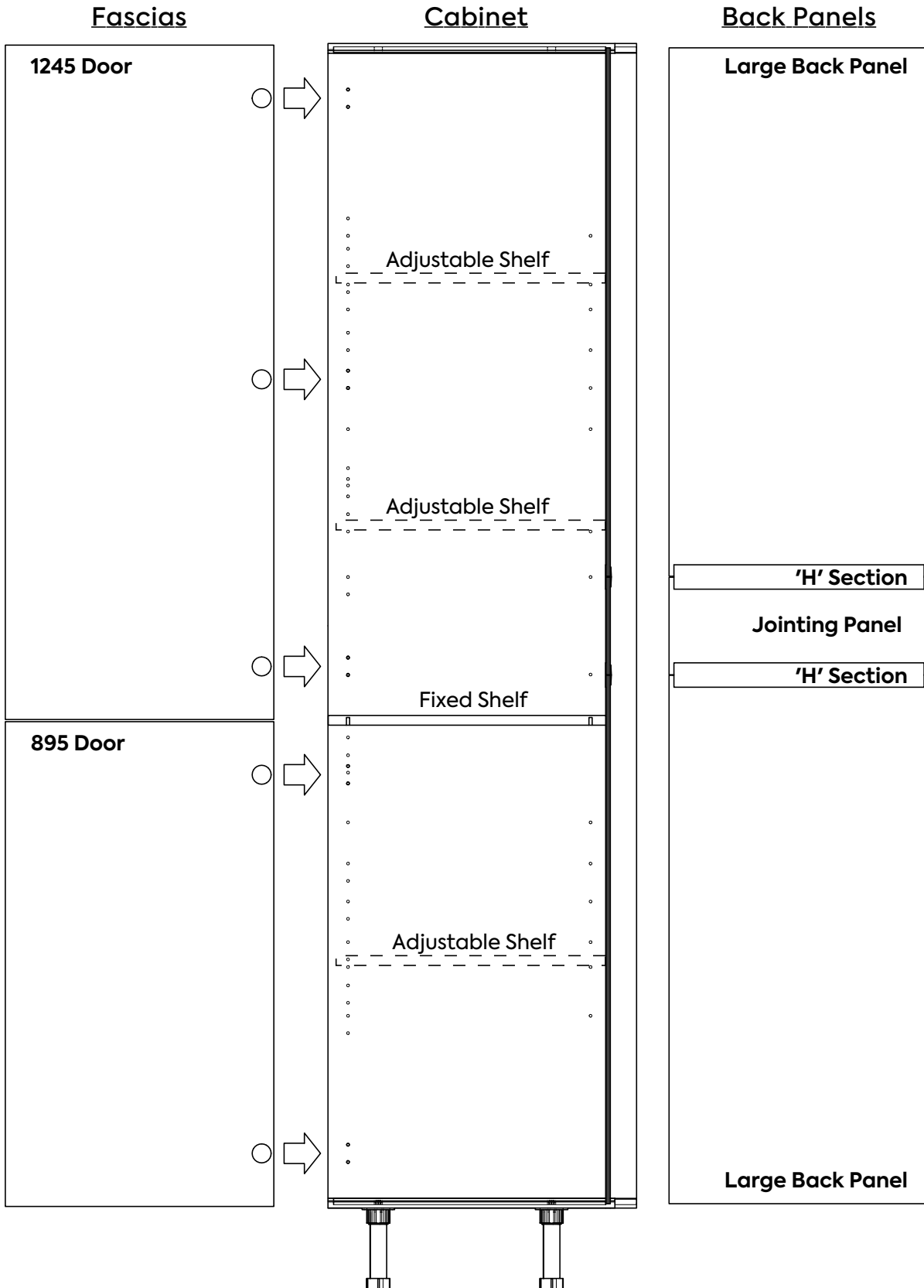

Tall Height (600 wide)

Larder Units

The primary function of this cabinet is as an appliance housing unit, however it can be used as a larder unit by fitting the three fixed shelves as shown

For drawer installation see Appendix

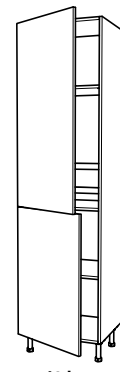

with Two Doors

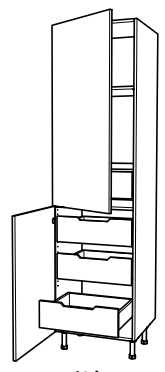

with Inner Drawers

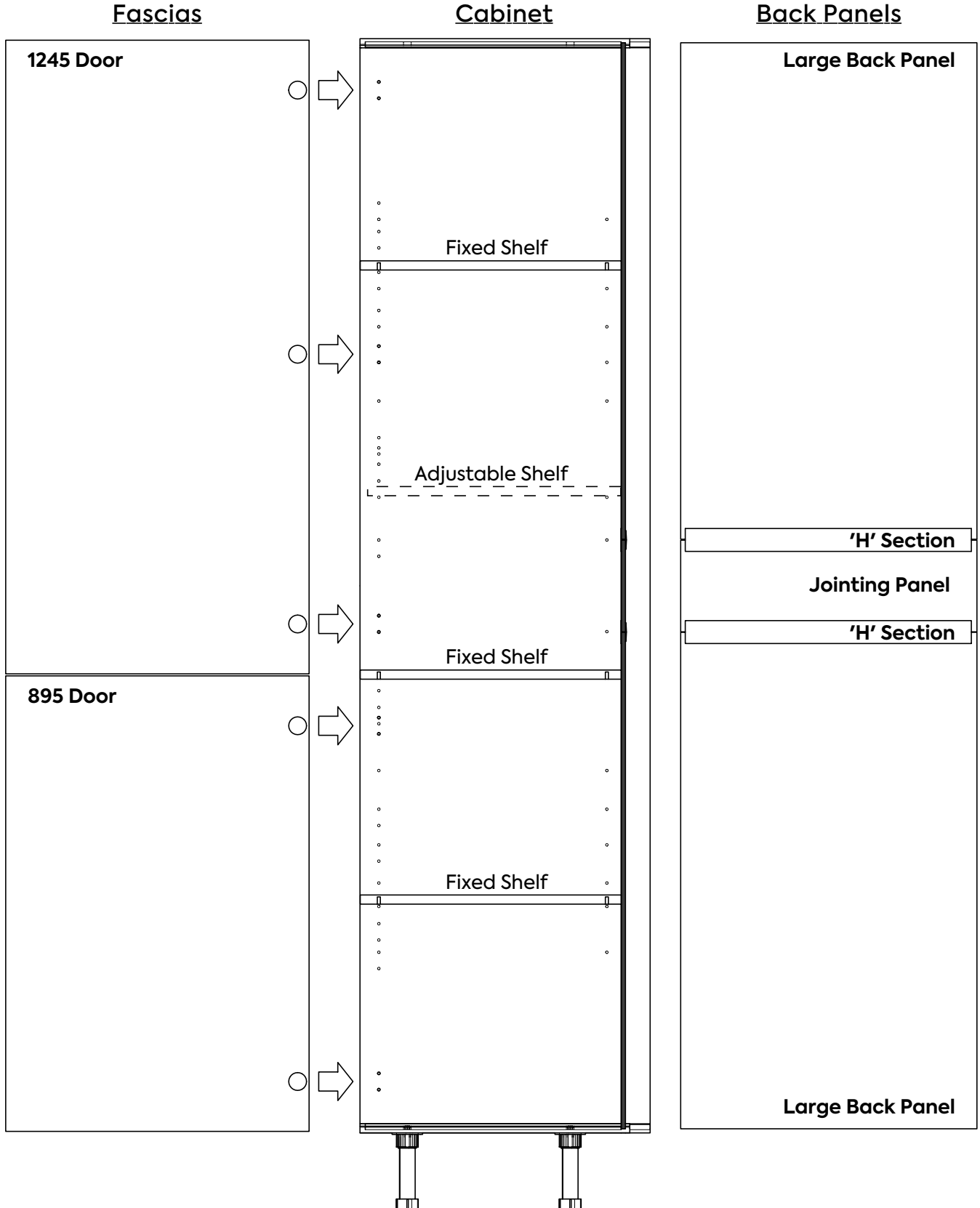

Double Oven Units

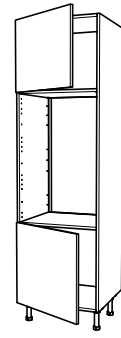

with
Two Doors

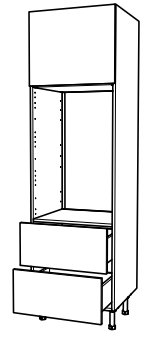

with
Pan Drawers

For drawer
installation
see Appendix

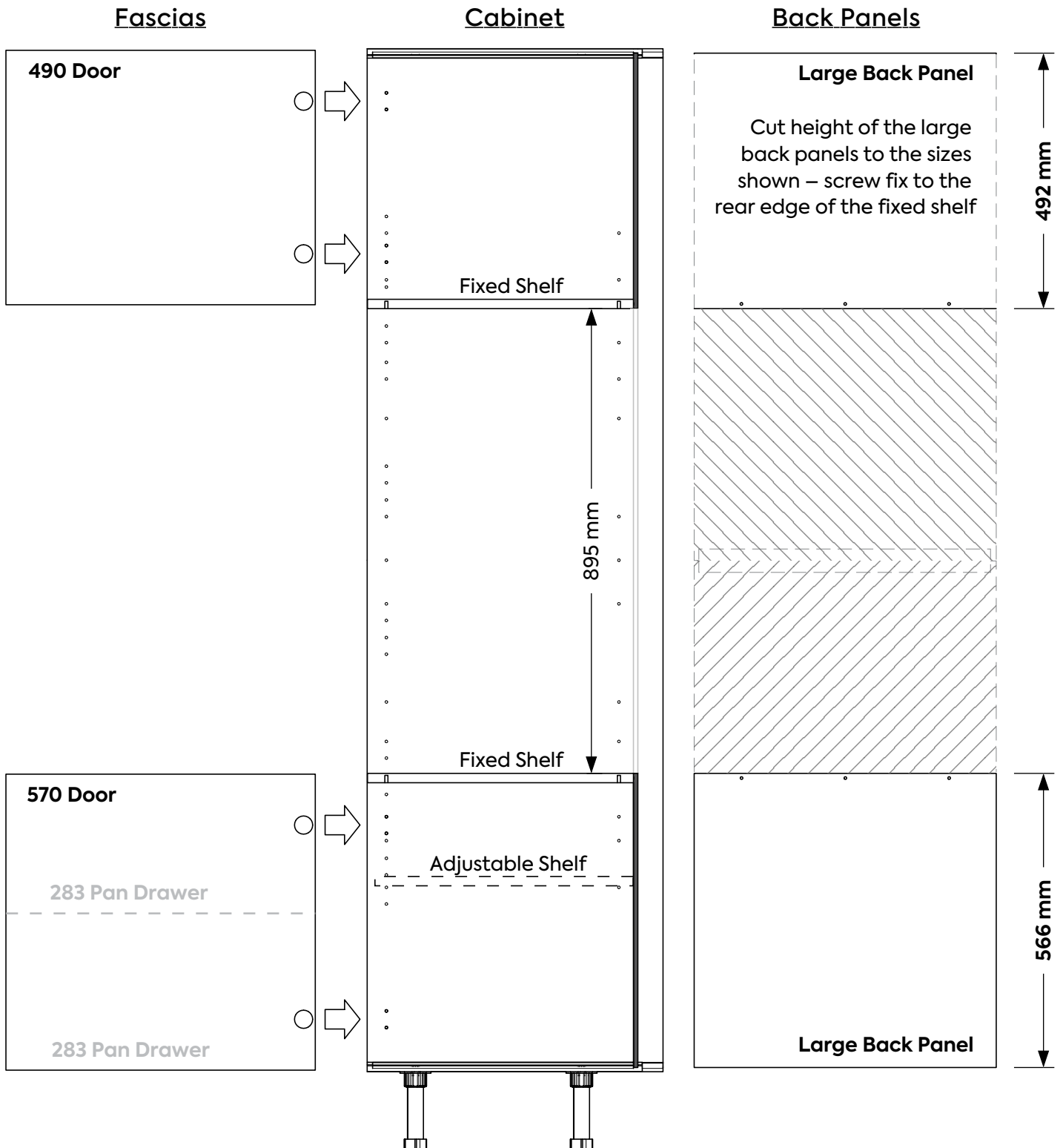

Standard Height Integrated Cooking
**Single Oven plus
 Compact/M-Wave Units**

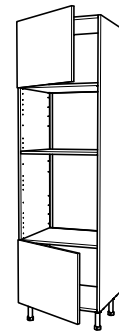

with
Two Doors

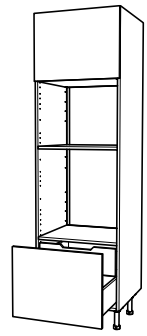

with Pan and
Inner Drawer

For drawer
installation
see Appendix

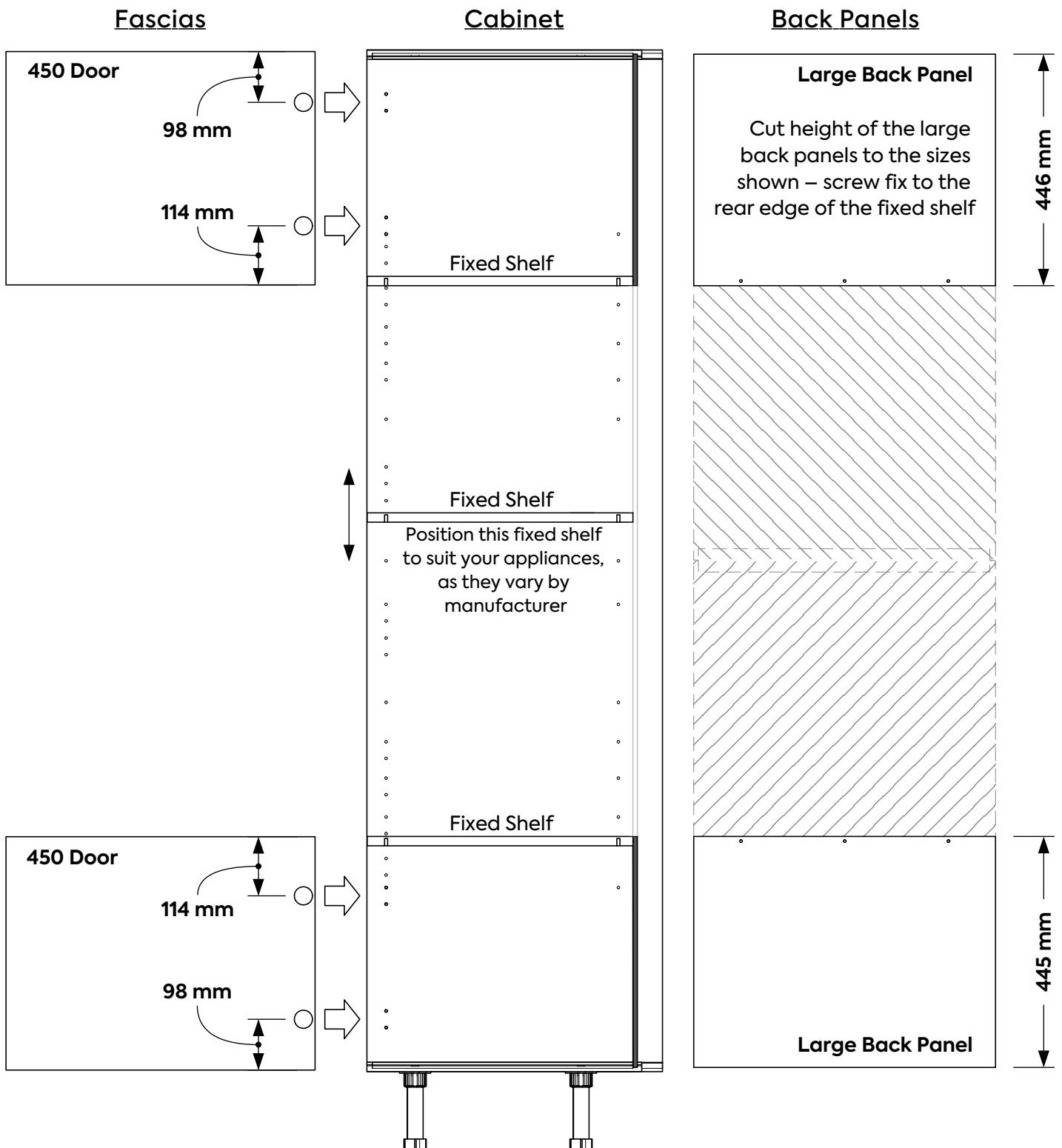

Standard Height Integrated Cooking Compact/M-Wave Units

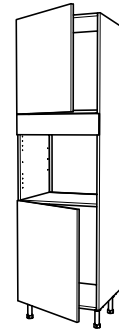

with
Two Doors

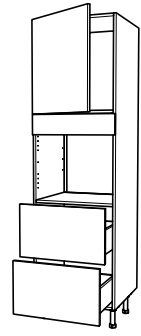

with
Pan Drawers

For drawer
installation
see Appendix

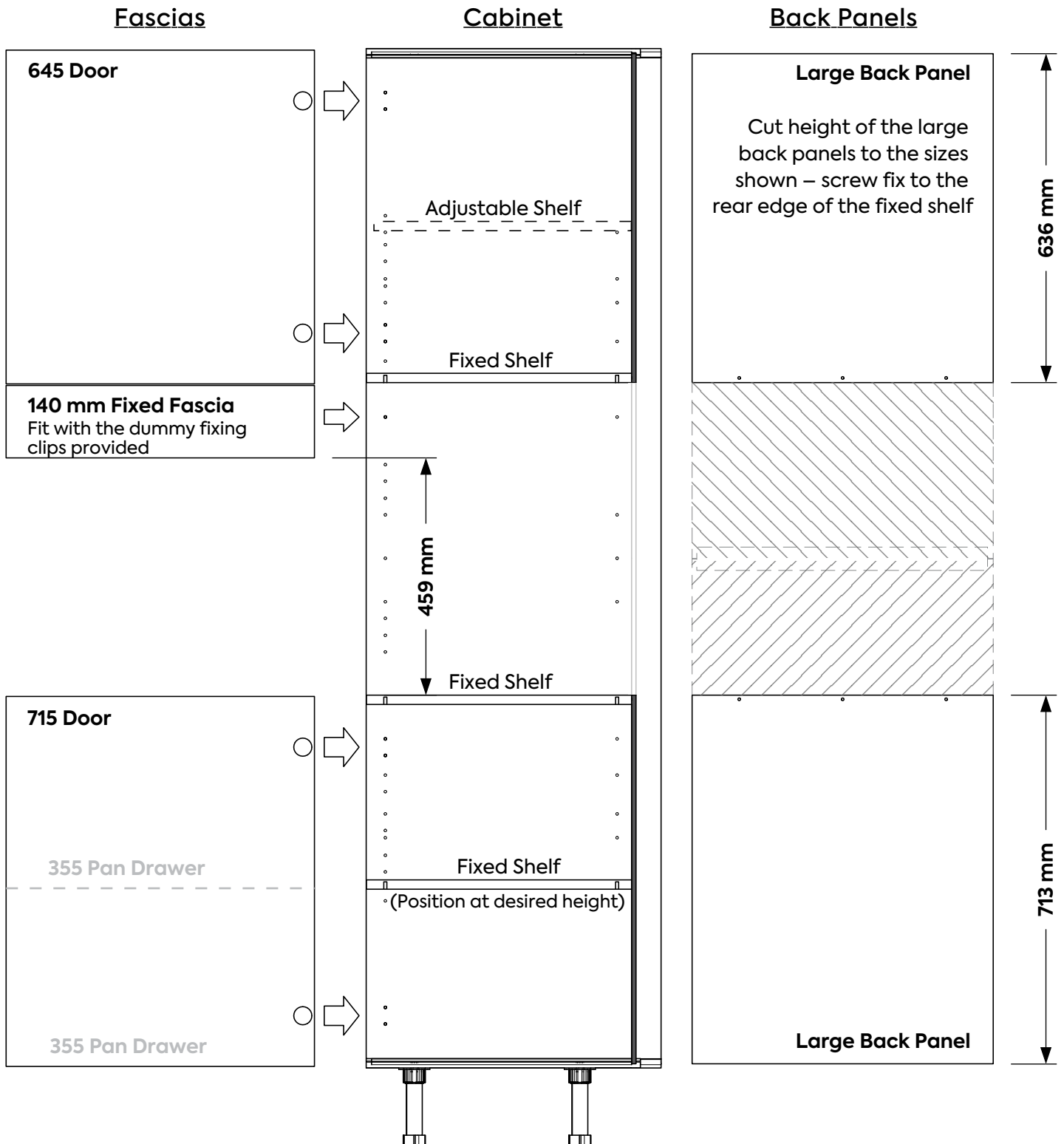

Tall Integrated Cooking Single Oven Units

For drawer installation
see Appendix

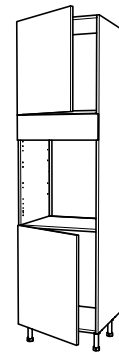

with
Two Doors

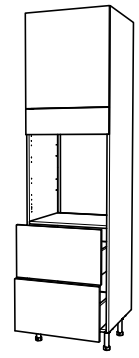

with
Pan Drawers

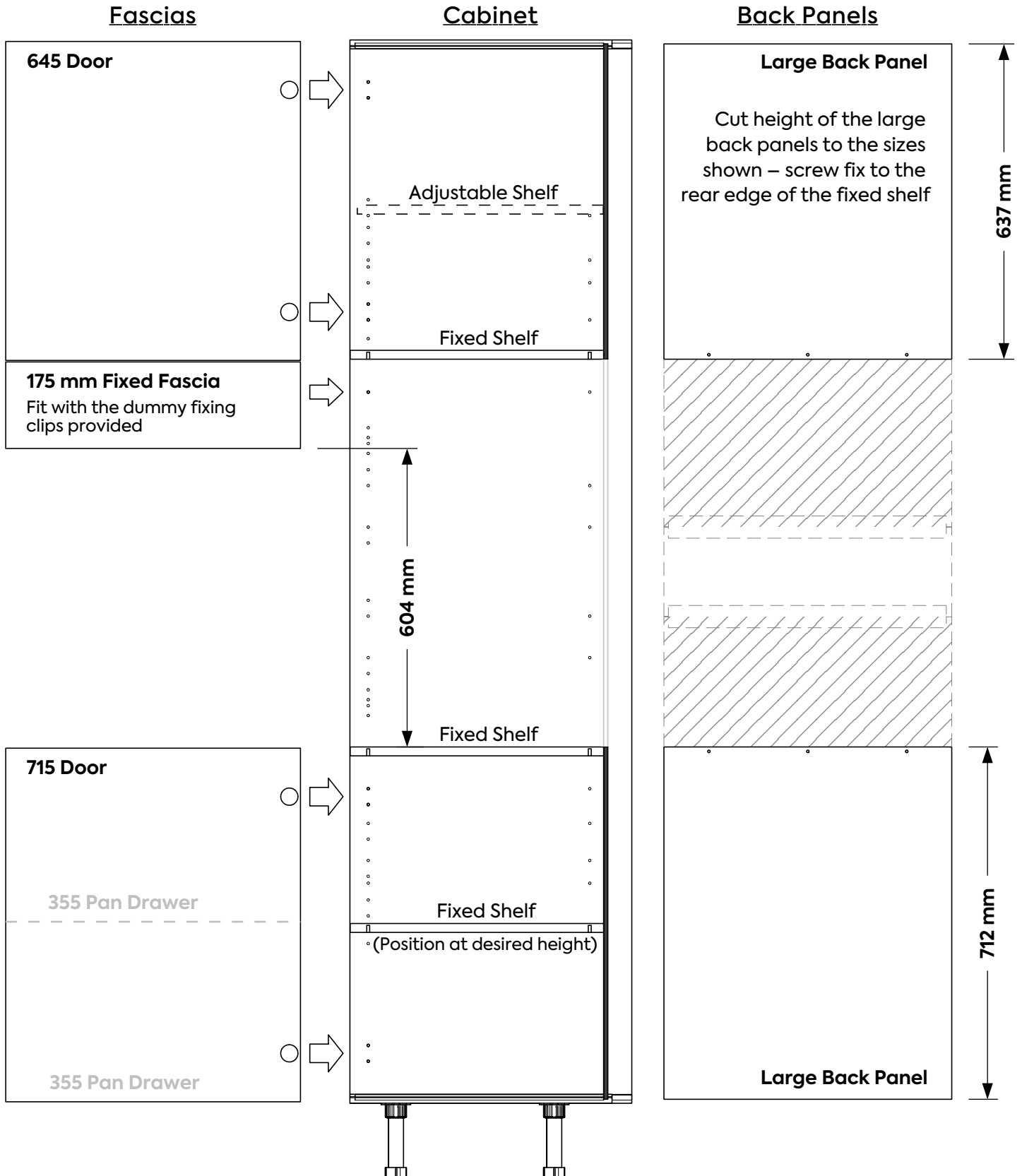

Tall Integrated Cooking Double Oven Units

For drawer installation
see Appendix

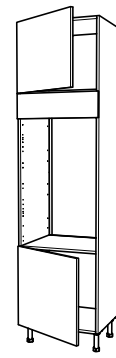

with
Two Doors

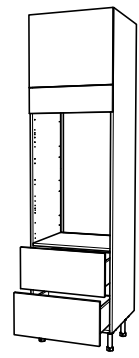

with
Pan Drawers

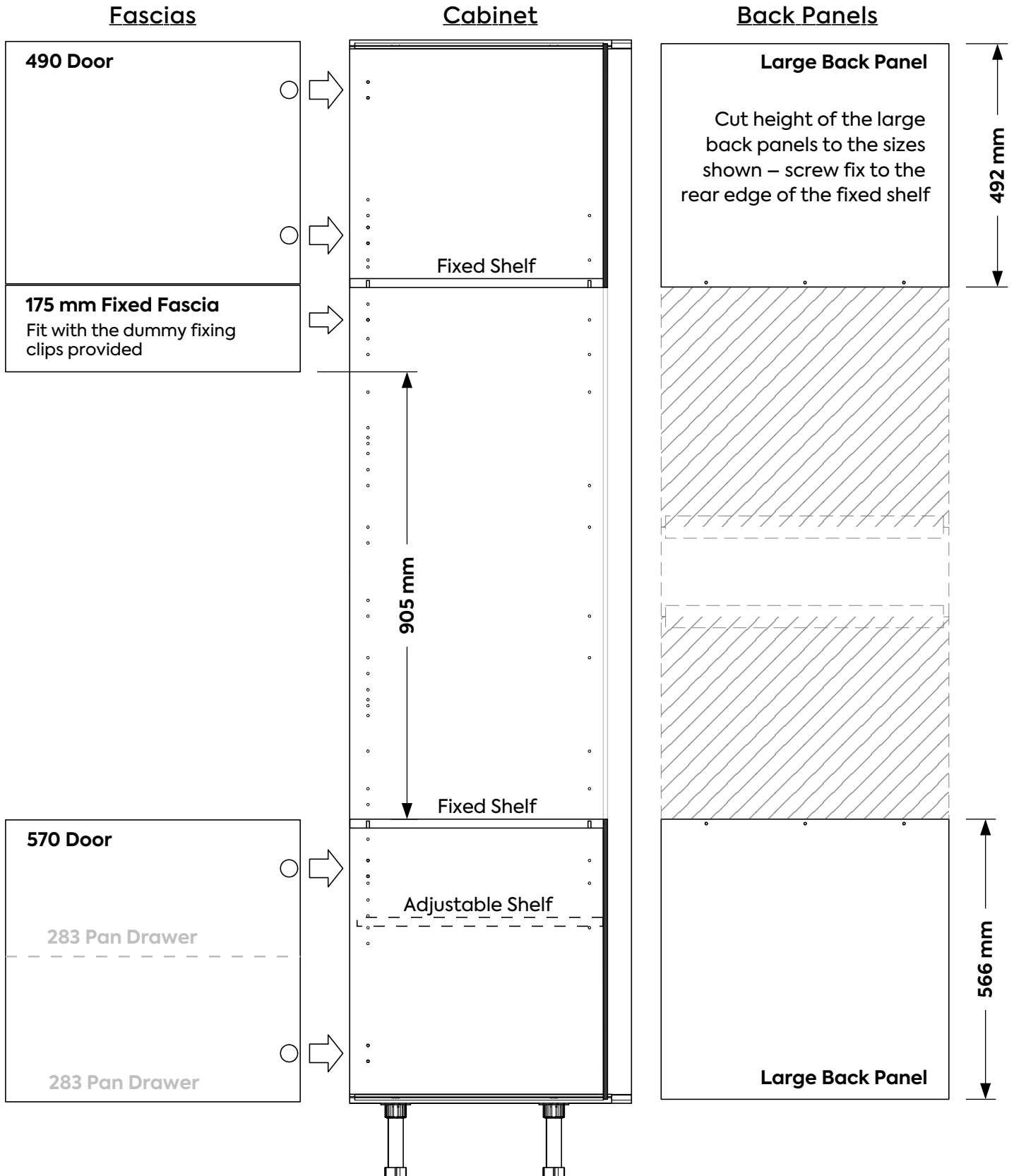

Tall Integrated Cooking Single Oven plus Compact/M-Wave Units

For drawer installation
see Appendix

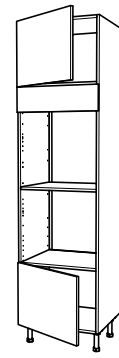

with
Two Doors

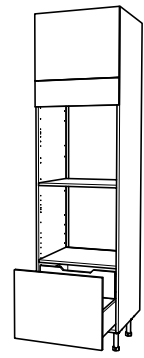

with Pan and
Inner Drawer

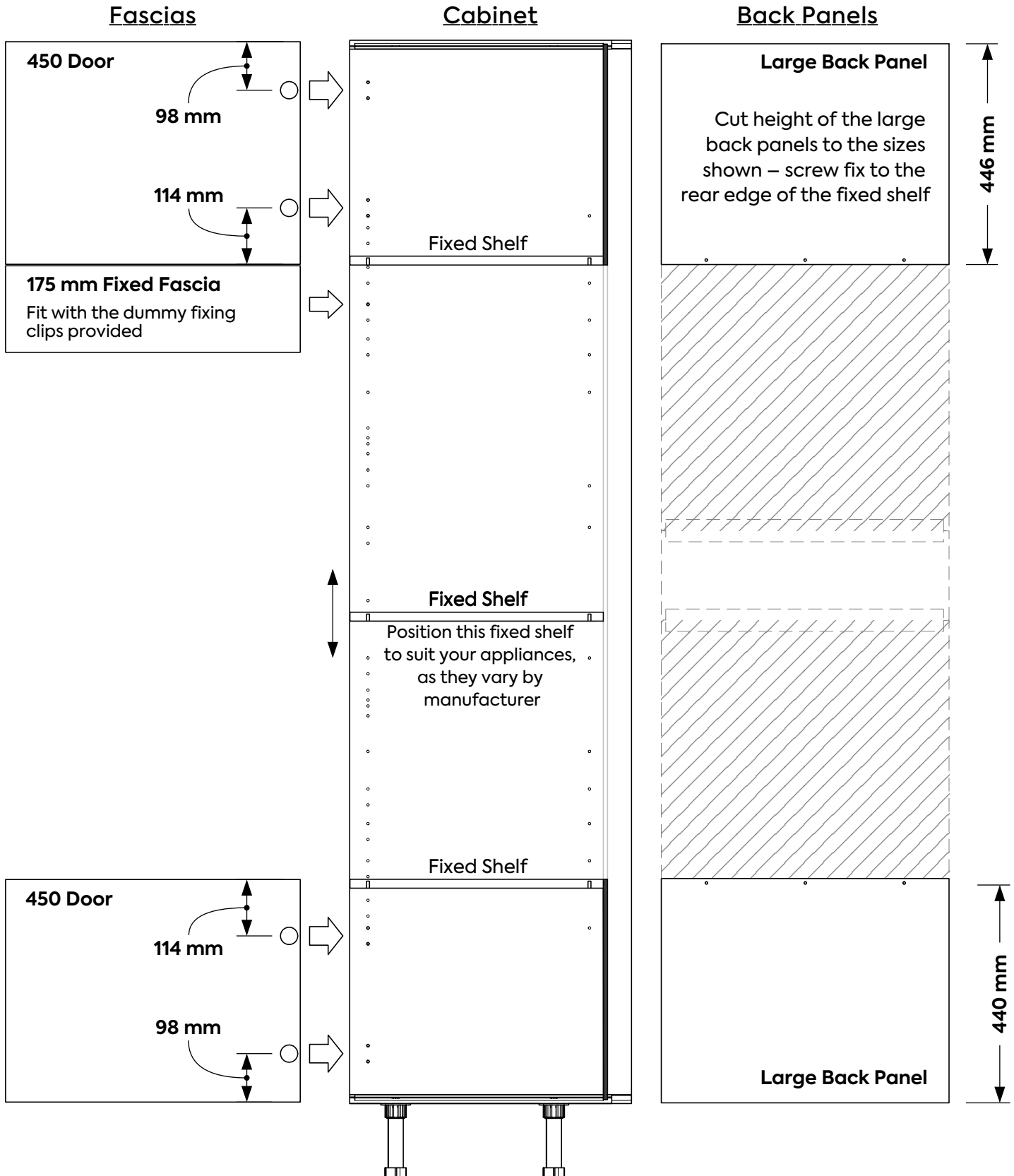

Tall Integrated Cooking Compact/M-Wave Units

For drawer installation
see Appendix

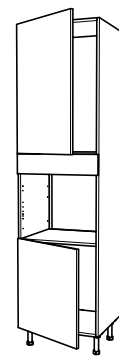

with
Two Doors

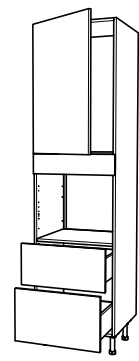

with
Pan Drawers

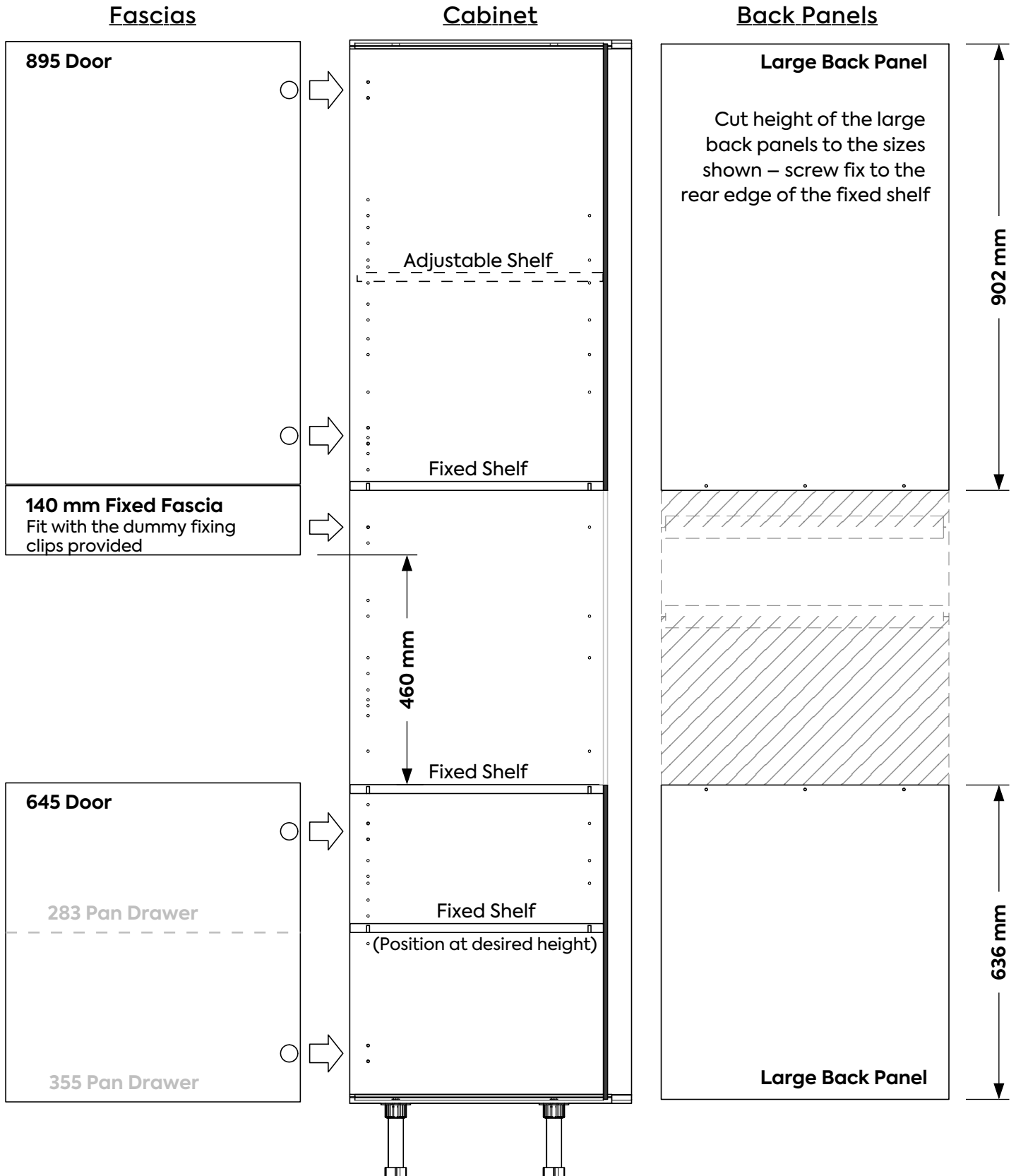

Standard Height Integrated Cooling 70/30 Cooling

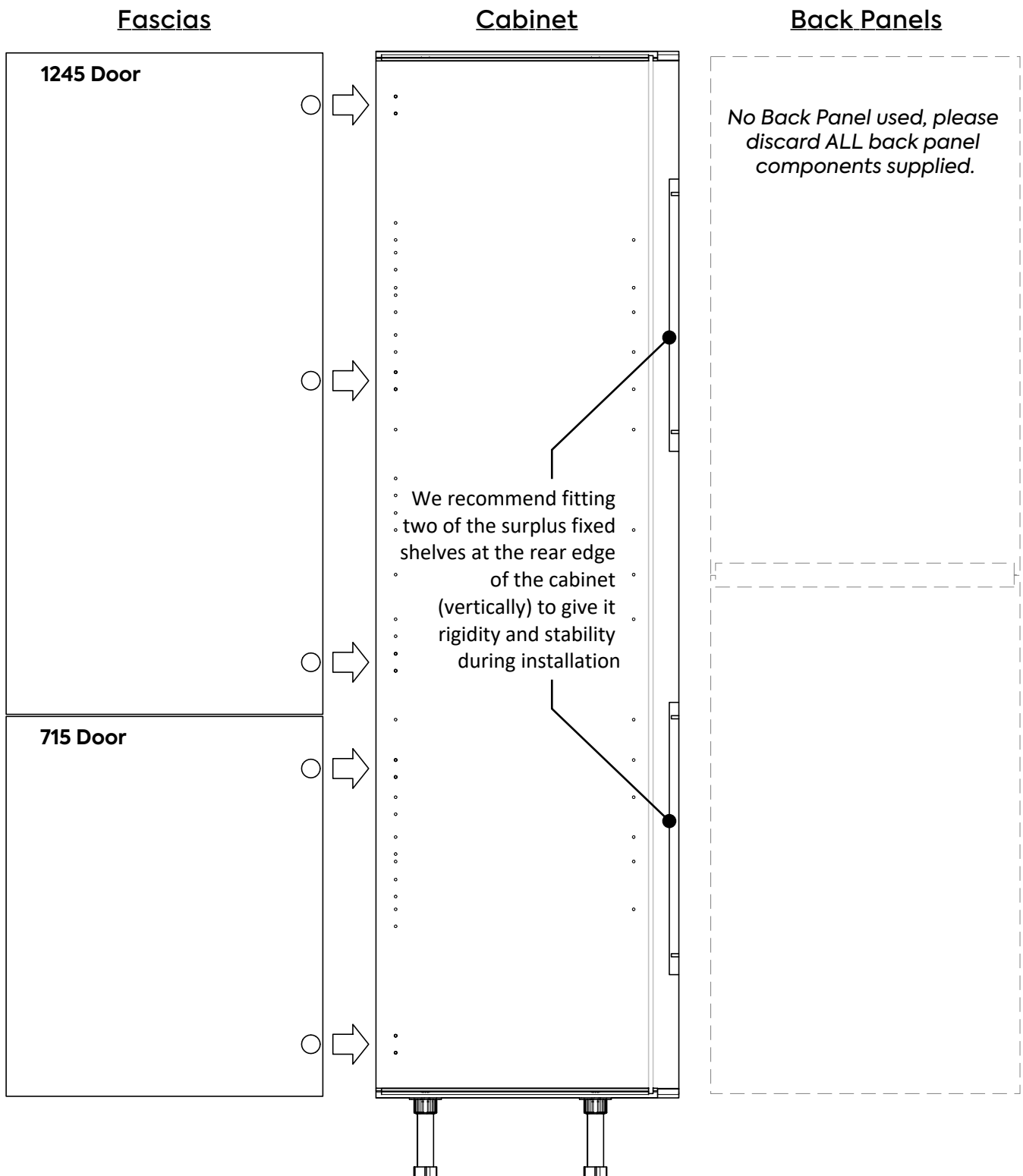
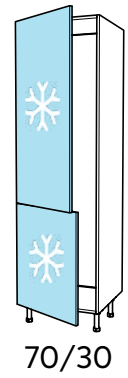

Standard Height Integrated Cooling

50/50 Cooling

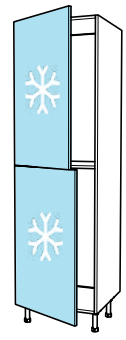

50/50

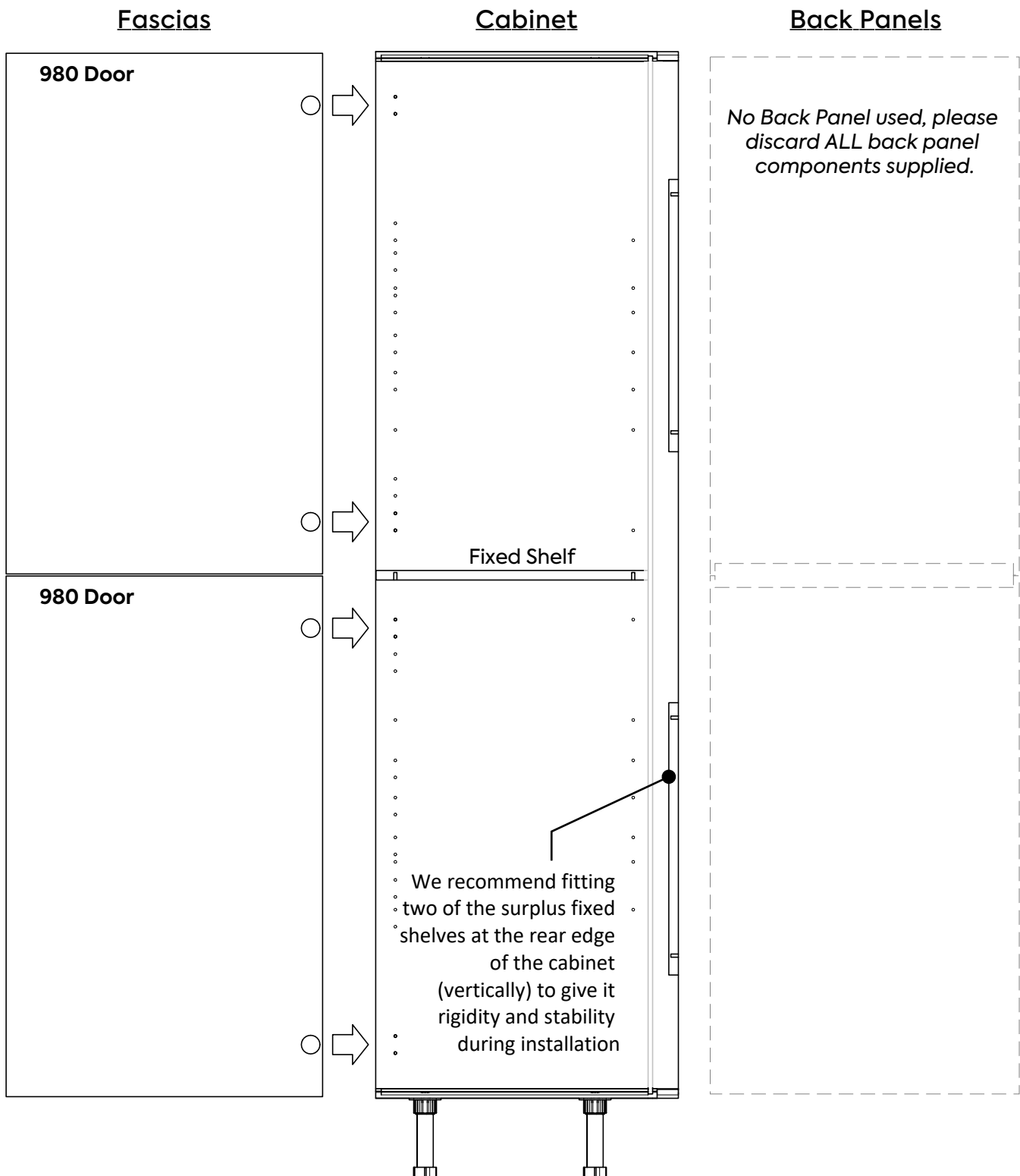

Standard Height Integrated Cooling
Single Cooling

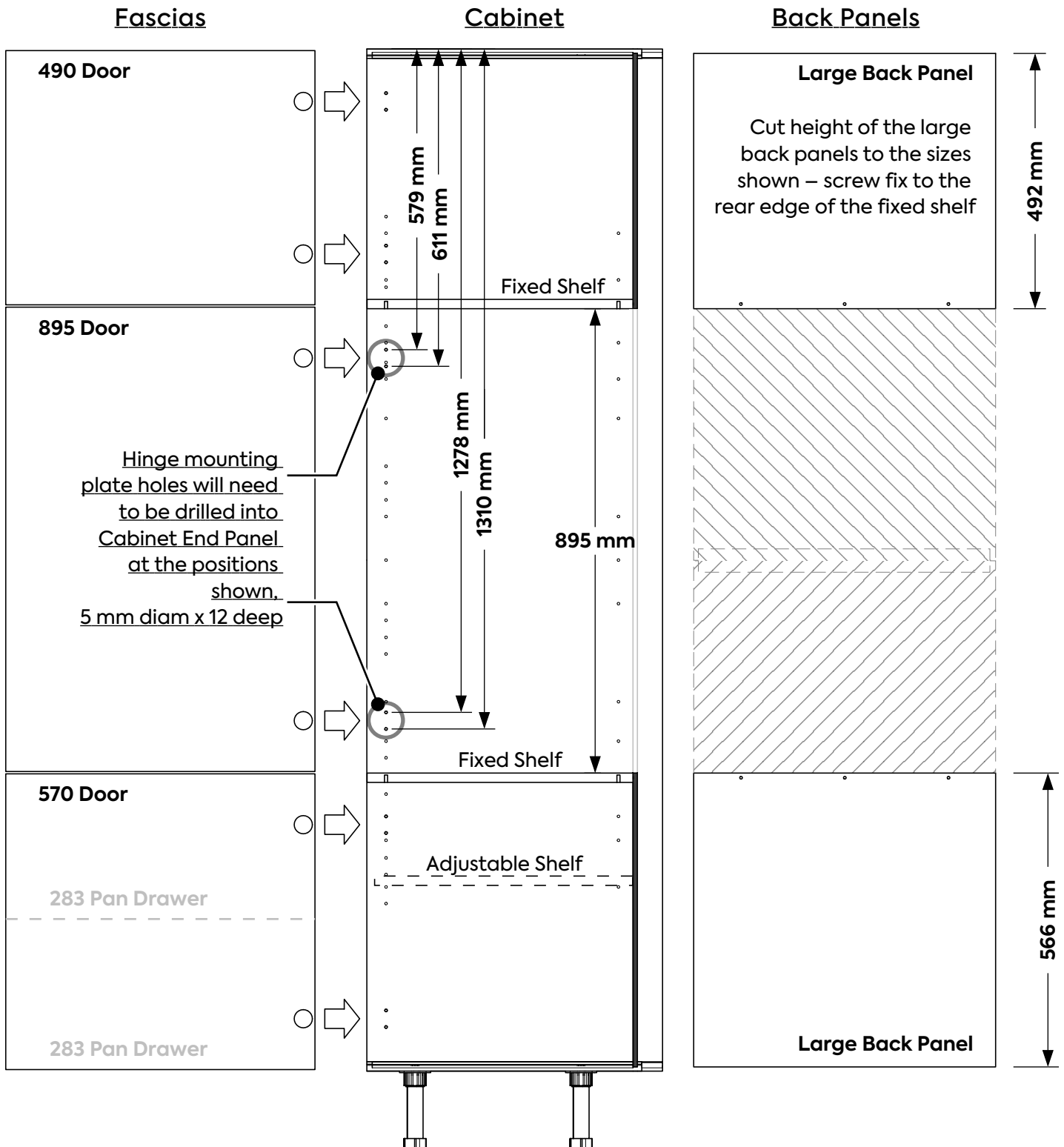
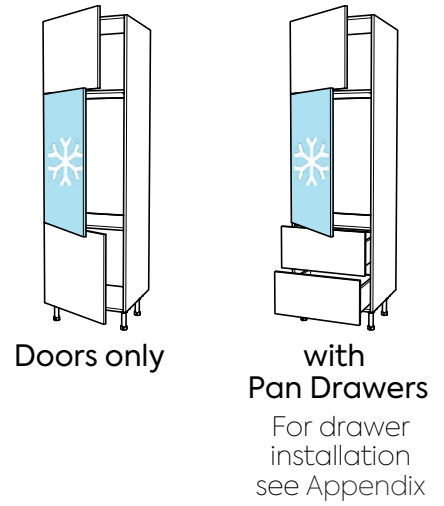

Tall Integrated Cooling 70/30 Cooling

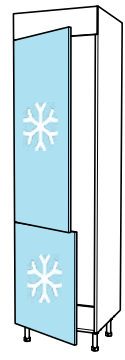

70/30

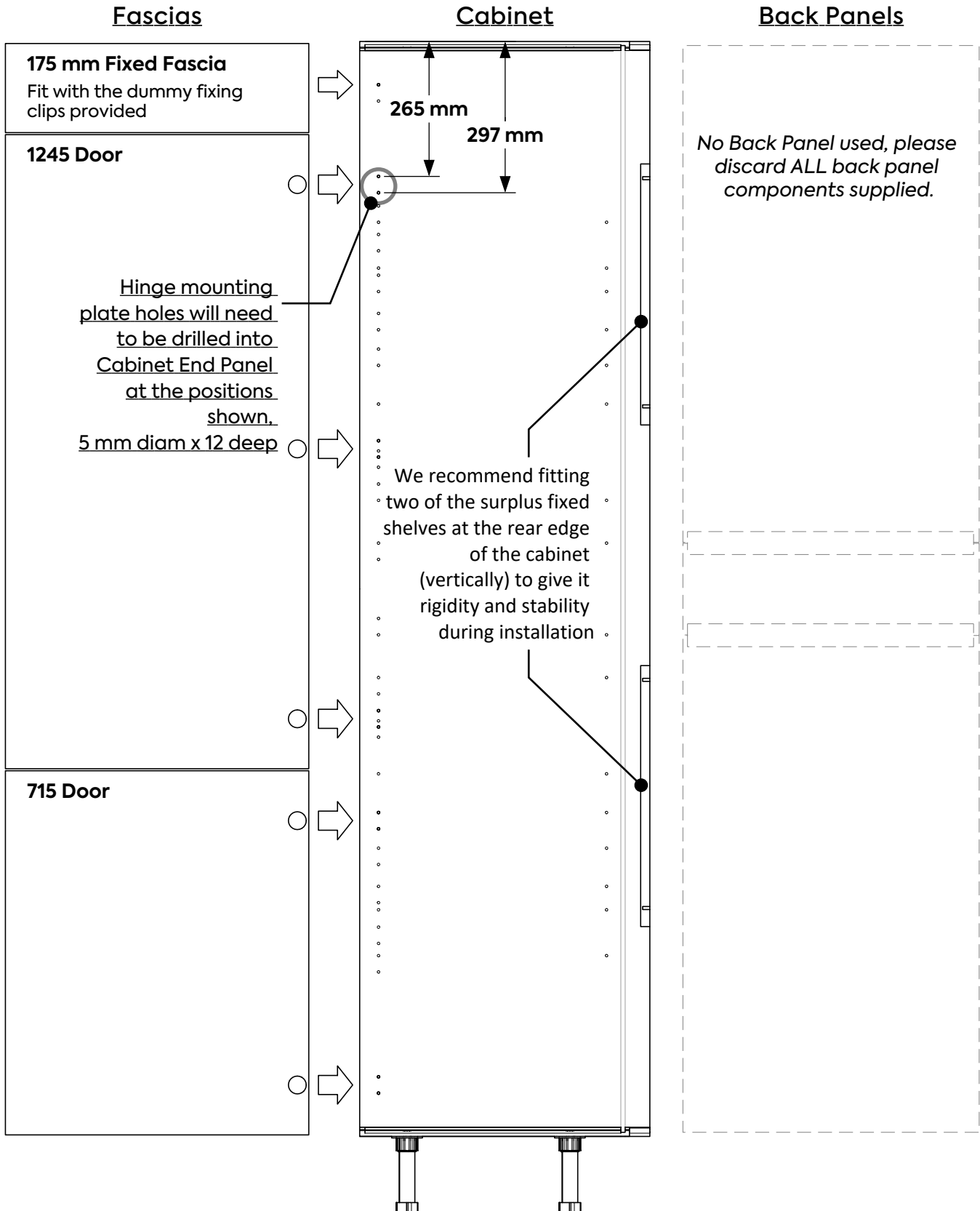

Tall Integrated Cooling 50/50 Cooling

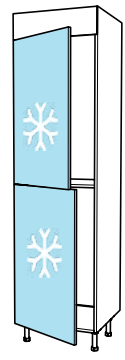

50/50

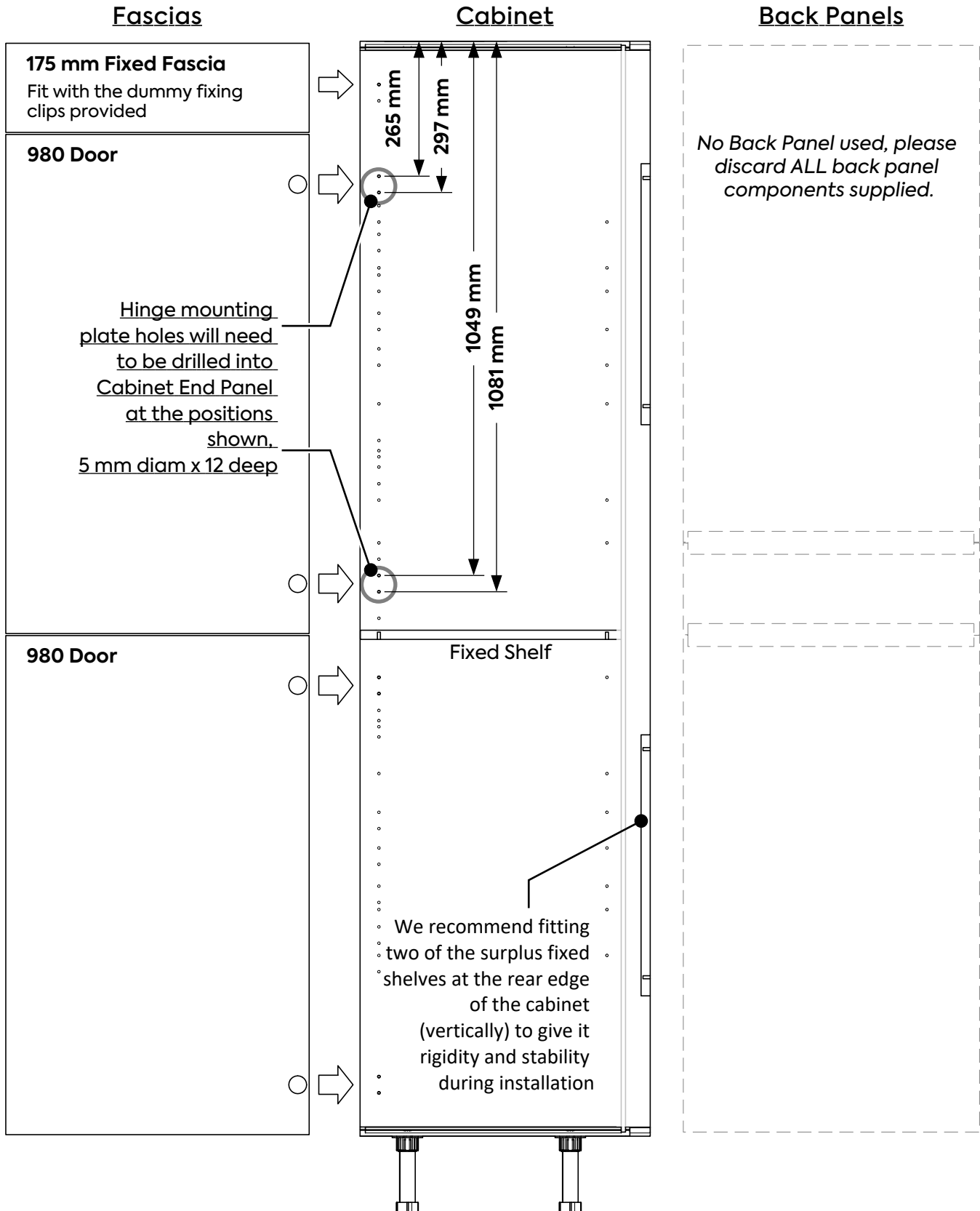

Tall Integrated Cooling Single Cooling

For drawer installation
see Appendix

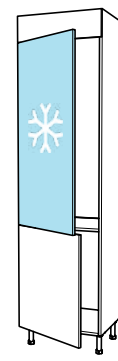

Doors only

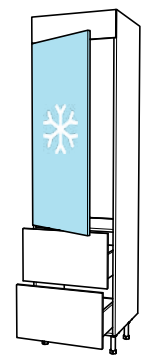

with
Pan Drawers

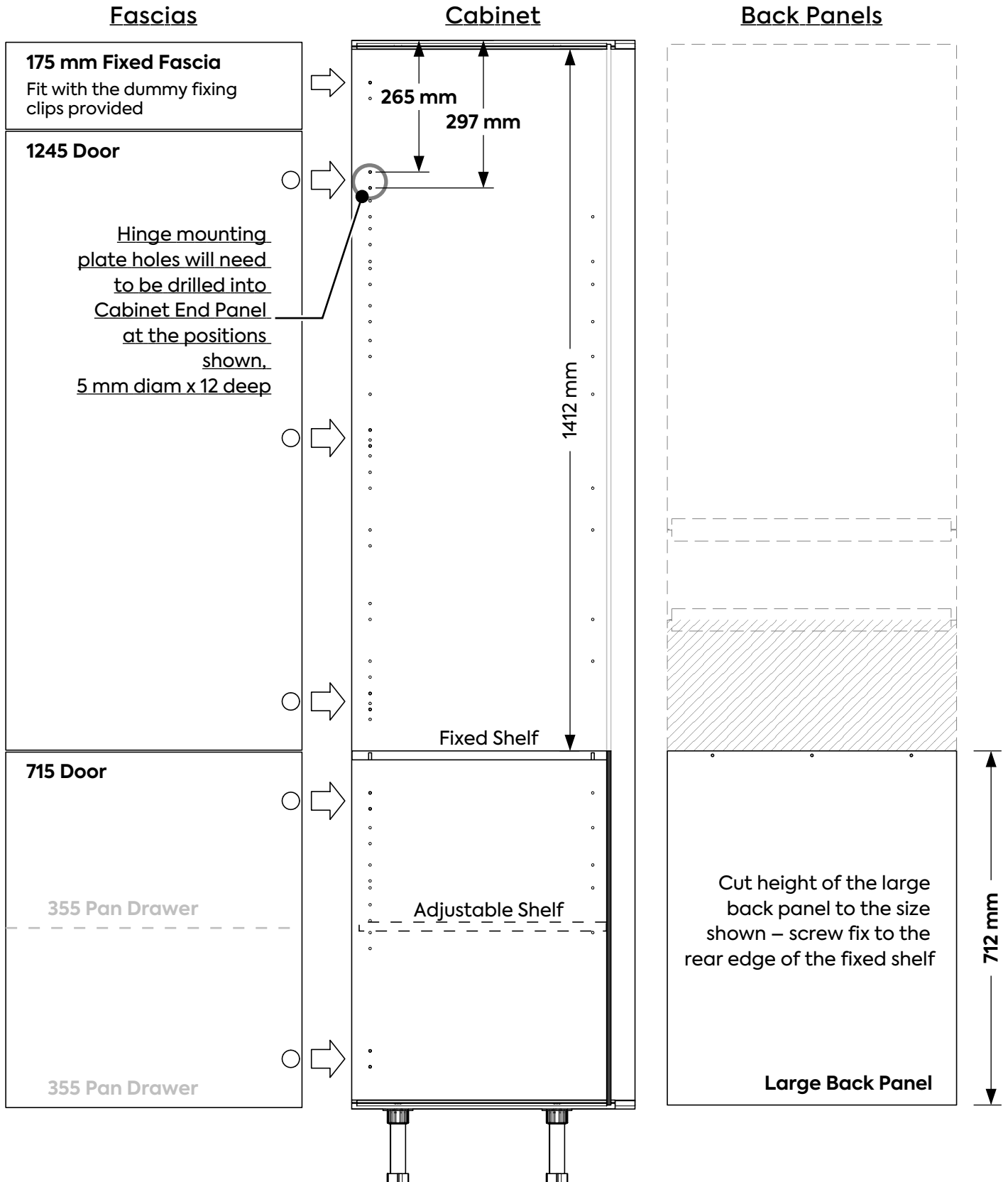

Appendix

Fixing cabinets to the wall

Please ensure the cabinet is fixed securely to the wall and also to the adjacent cabinets.

- For 600 wide appliance housing units, this can be done using metal angle brackets or appropriate fixings (not supplied) behind the appliance, before it is slid into position.
- For Larder Units, this can be done at the top of the cabinet, using metal angle brackets or appropriate fixings (not supplied). It is essential that the cabinet is prevented from tipping forward, which could cause injury or damage.

Fixed Shelves

The fixed shelf system uses a metal camlock housing, together with a screw-in bolt that fixes into the cabinet end panel.

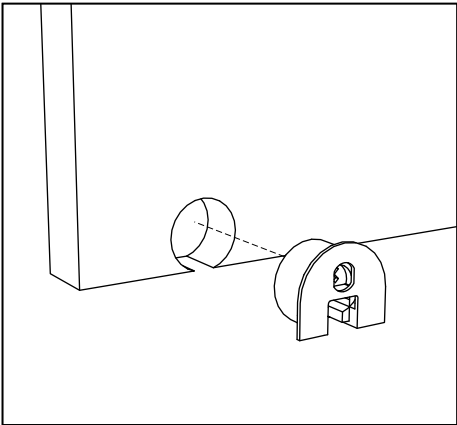

1. Use a soft rubber mallet to tap the Rafix connector housing into the pre-drilled holes.

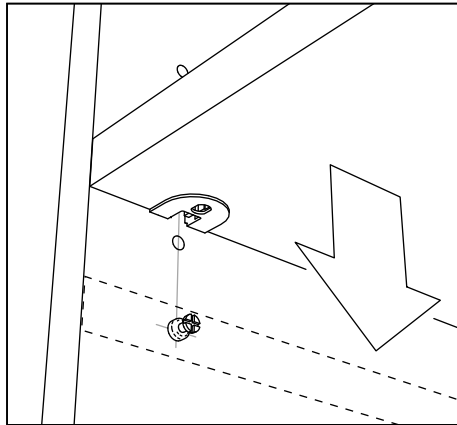

2. The screw-in bolt fixes into the relevant holes in end panel; do not overtighten. The shelf drops into position as shown.

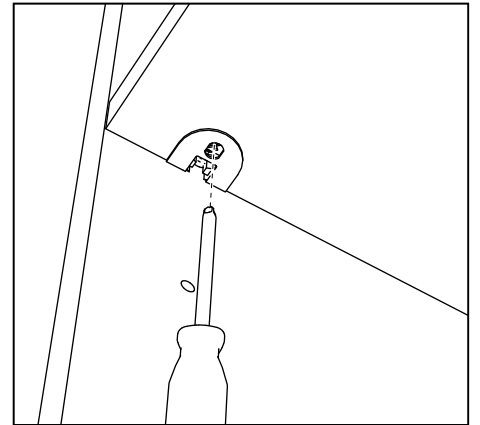

3. Lock off the fittings via the posidrive screw head inside the Rafix housing.



NOTE

All appliances must be seated on a Fixed Shelf. Never use an adjustable shelf for this purpose.

Fixed Dummy Fascias

Dummy drawer fixing clips are supplied for use with specific configurations where a fixed panel is used above the appliance.

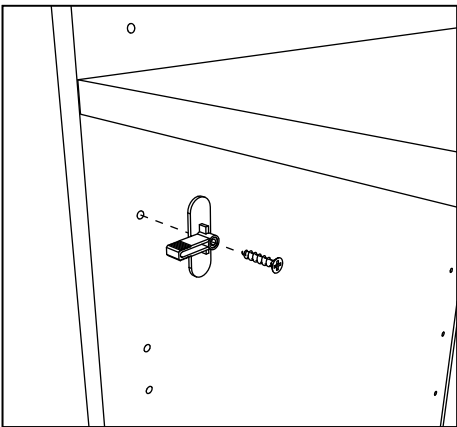

1. Screw dummy drawer clips (male) to tower end panels utilizing one of the pre-drilled holes (37mm from front edge).

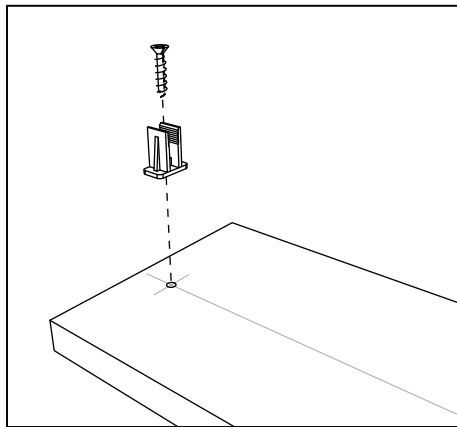

2. Carefully measure and mark position of dummy drawer clip (female) and screw to fascia.

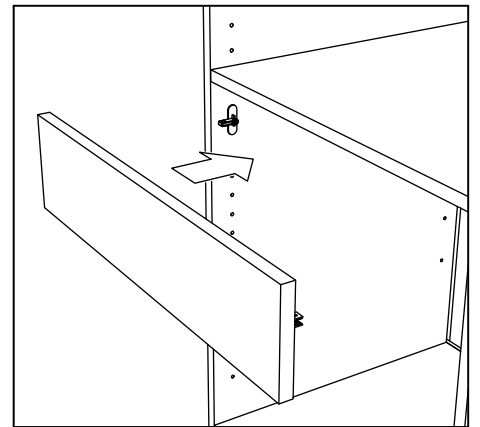

3. Attach Fixed Fascia

Inner Drawers

For inner drawer options, the drawer runner positions will need to be marked out and drilled in the positions shown, to suit the Hettich inner front panel system. These positions allow for clearance between door hinges.

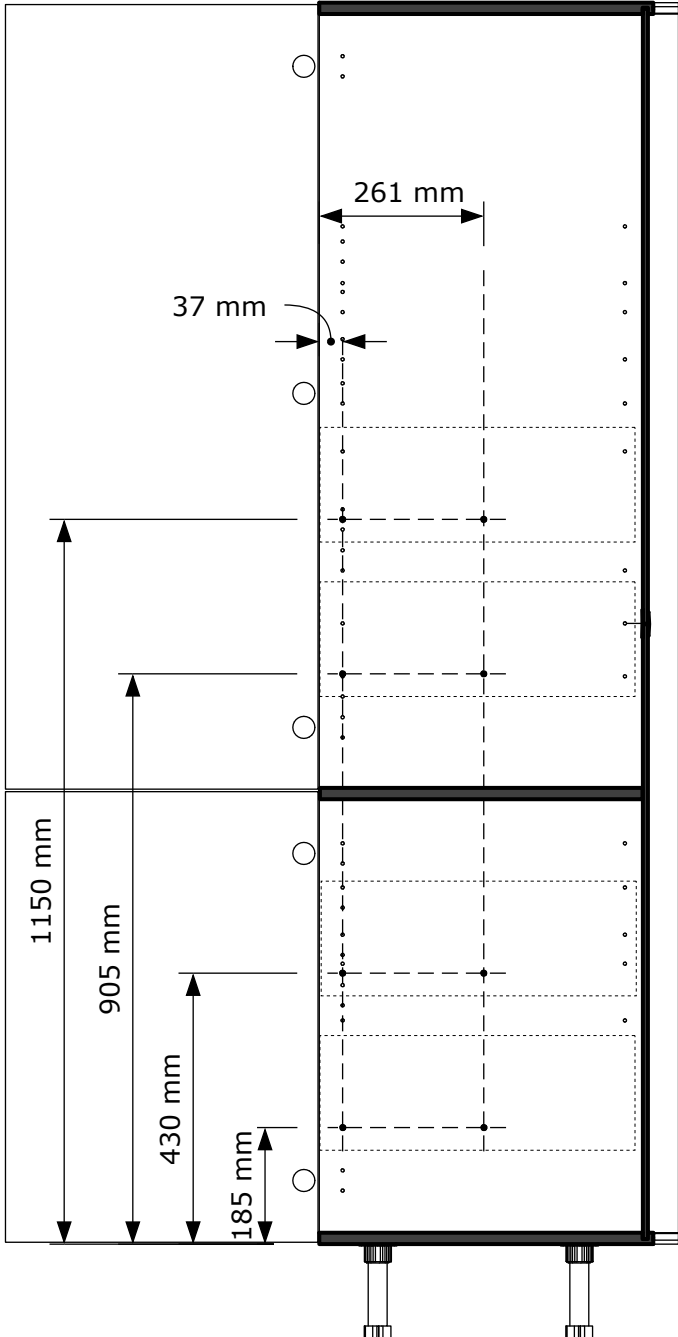

Inner Drawers in
Standard Larder Unit

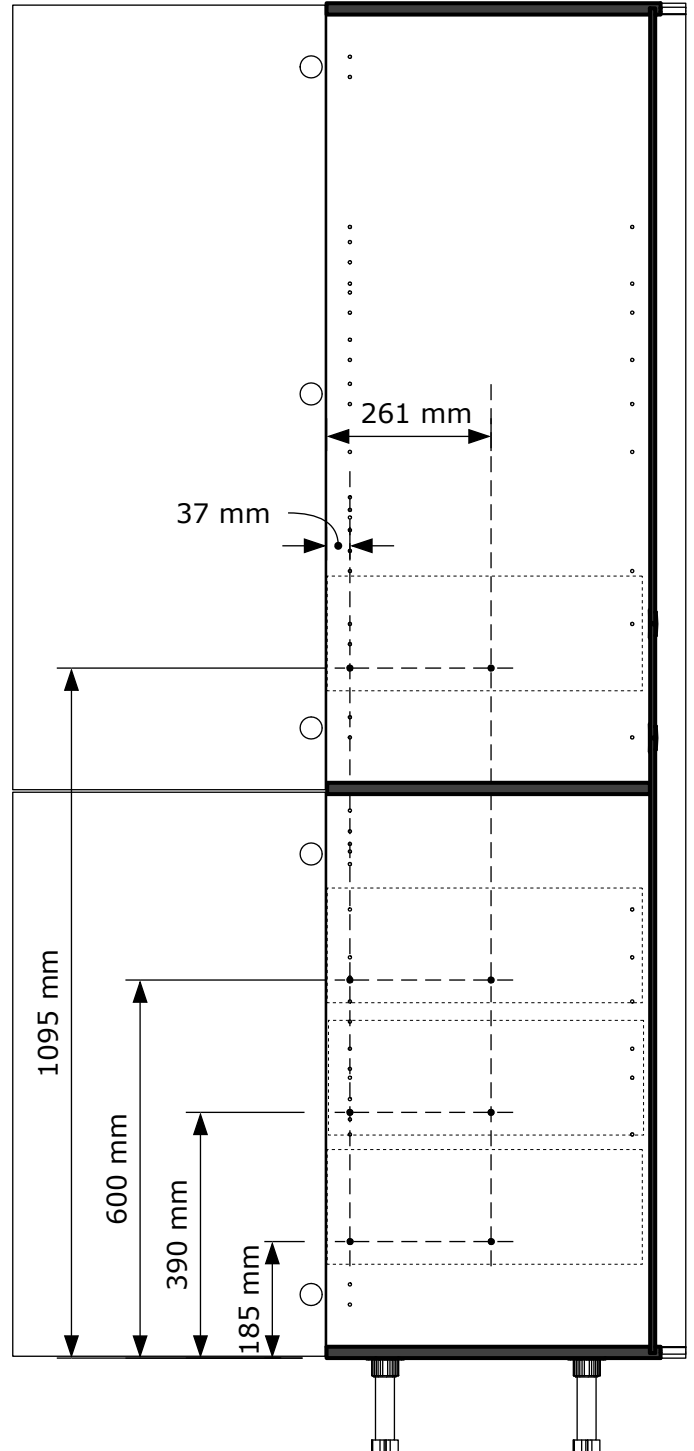

Inner Drawers in
Tall Larder Unit

Pan Drawers

For pan drawer options, the drawer runner positions will need to be marked out and drilled in the positions shown, to suit the Hettich inner front panel system.

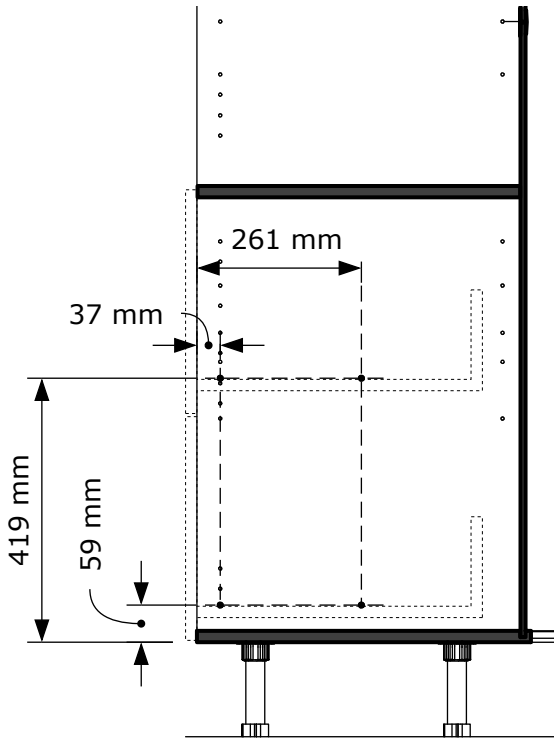

Two 355 mm Pan Drawers

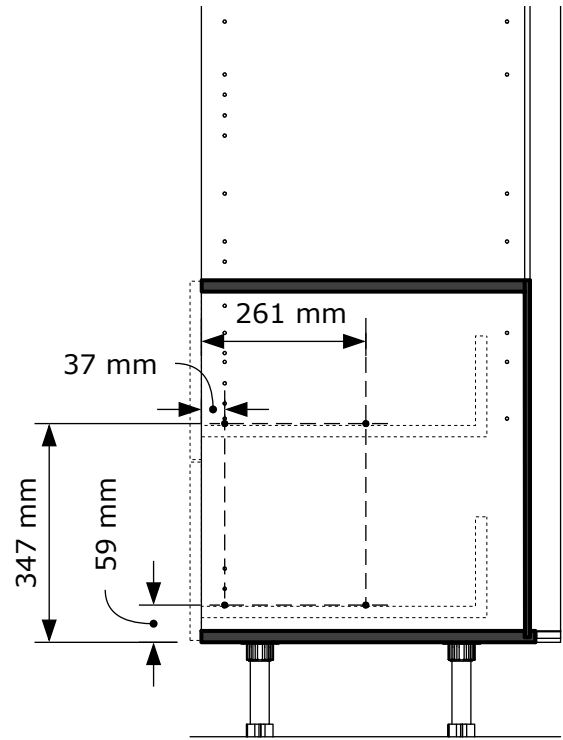

Two 283 mm Pan Drawers

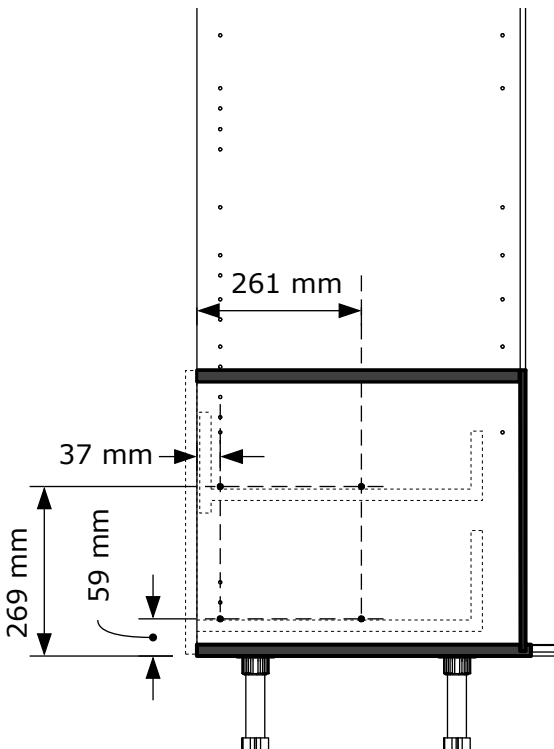

450 mm Pan Drawer with Inner Drawer

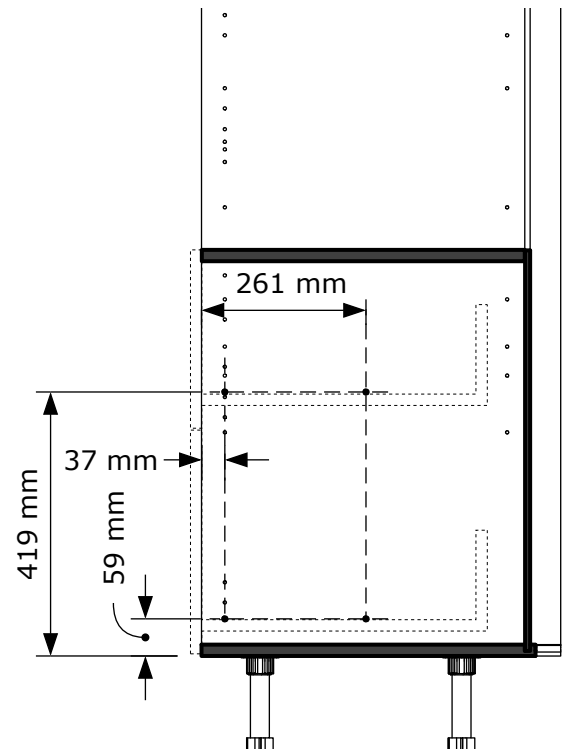

355 and 283 mm Pan Drawers